

July 15, 2004

Rafael Ramos  
PAMIGE Ranch  
6671 Stove Prairie Road  
Bellvue, CO 80512

Dear Rafael:

This is a reminder that your Forest Land Enhancement Program (FLEP) grant project must be completed by September 15, 2004.

As you recall, the FLEP Grant requires a 50/50 fund match. In your original packet you received an Accomplishment Report for Reimbursement, a Cost Document form, and a W9. Upon completion of the practice, contact our office to schedule a final inspection. All costs and revenues must be documented on the above forms. The W9 must be completed and returned to assure reimbursement. Final reimbursement cannot be processed without completion of these forms.

If you will be unable to complete the project, please notify us as soon as possible, so that we may adjust your grant and reallocate the remaining funds to other projects.

If you have any questions, please call me at (970) 491-8839, or Mike Hughes (970) 491-8453, or the Fort Collins District office (970) 491-8660.

Sincerely,

Norland K. Hall  
Forester

*File Copy*



Fort Collins District  
5075-Campus Delivery, CSU  
Fort Collins, CO 80523-5075  
(970) 491-8660  
FAX (970) 491-8645

September 22, 2003

Rafael Ramos  
PAMIGE Ranch  
6671 Stove Prairie Road  
Bellvue, CO 80512

Dear Ray,

Your Forest Land Enhancement Program (FLEP) grant application has been reviewed and funding approved as shown on the attached copy of your application. Our office received over \$120,000 in grant requests. Needless to say we were not able to fund all projects. In most cases, we were able to partially fund a project.

Before you begin project implementation please contact our office to schedule a site visit to review the project and accomplishment standards and expectations. We hope this alleviates any surprises when the final inspection is completed. Please review the attached standards prior to the site visit.

As you recall, the FLEP Grant requires a 50/50 fund match. The project must be completed by September 15, 2004. If it becomes apparent you will not be able to the project by this day, please contact our office as soon as possible.

Enclosed you will also find an Accomplishment Report for Reimbursement, a Cost Documentation form, and a W9. Upon completion of the practice contact our office to schedule a final inspection. All costs and revenues must be documented on the above forms. The W9 must be completed and returned to assure reimbursement. Final reimbursement cannot be processed without completion of these forms.

If you have any questions, please contact our office at (970) 491-8660.

Sincerely,

A handwritten signature in cursive script that reads "Dave Farmer".

David A. Farmer  
Assistant District Forester

Enclosures



COLORADO'S  
**FLEP** FOREST LAND  
 ENHANCEMENT PROGRAM  
 APPLICATION FOR COST-SHARE

**PROJECT NUMBER:** \_\_\_\_\_  
 (For Official Use Only)

**NAME:** Rafael A. Ramos  
**MAILING ADDRESS:** PANIGE Ranch, 6671 Stove Prairie Road  
**City:** Bellvue **State:** CO  
**Zipcode:** 80512  
**TELEPHONE NO:** 970-482-7262

**PROJECT ADDRESS/LEGAL DESCRIPTION:** same as above

**PRACTICES TO BE COMPLETED BY:** July 30, 2004

| Practice No. & Component Title | Quantity Requested | Quantity Approved | Maximum C/S Amount | C/S Amount Requested | C/S Amount Approved |
|--------------------------------|--------------------|-------------------|--------------------|----------------------|---------------------|
| FLEP-9 666-6.302               |                    |                   |                    |                      |                     |
| Defensible space               | 1                  | 1 EA              | 1200.00            | 1200.00              | \$1,200.00          |
| FLEP-3 666-1                   |                    |                   |                    |                      |                     |
| Thinning                       | 5 ac.              | 2 AC              | 2500.00            | 2500.00              | \$1,000.00          |
| FLEP-3, 7, (9) 666-2           |                    |                   |                    |                      |                     |
| slash disp. (burning) 2 ac.    | 2 ac.              | 2 AC              | 200.00             | 200.00               | \$ 200.00           |
| FLEP 3, 7, (9) 666-3           |                    |                   |                    |                      |                     |
| Slash disp. (chipping) 3 ac.   | 3 ac.              | 0                 | 900.00             | 900.00               | 0                   |
| <b>Total:</b>                  |                    |                   |                    | 4800.00              |                     |

Request for cost-share assistance under this program is to meet the objective stated in the management plan. If cost-sharing is approved for the practice requested, I agree to cover expenses at the time of implementation, knowing I will be receiving cost-share funds not exceeding 50% of actual cost. **I understand that I will not be reimbursed for any expenses incurred prior to approval of my application.** Work must be completed according to approved plan and application, and must meet the standard set for each component. Practices must be maintained for a minimum of 10 years. There are no partial payments.

**LANDOWNER SIGNATURE:** Rafael A. Ramos **DATE:** 7/31/03

**CSFS FIELD REVIEW SIGNATURE:** \_\_\_\_\_ **DATE:** \_\_\_\_\_  
 (Additional USFWS guidelines addressed)

**C/S APPROVED:** David A. Farmer **AMOUNT:** \$2,400.00 **DATE:** 9-22-03

Program eligibility is without regard to race, color, religion, national origin, age, gender, sexual orientation, veteran status or disability. For more information contact your local Colorado State Forest Service District Office.

**ADDRESS: 6671 Stove Prairie Road, Bellvue CO 80512**

**DEFENSIBLE SPACE**  
FLEP-9 666-6.302

Project: Consists in removing approximately 20 trees close to the buildings. See attached sketch. Remaining trees will be limbed. In addition old fencing will be removed and tall grass around buildings will be mowed. Project is expected to be completed by December 2003.

**THINNING**  
FLEP-3 666-1

Project: Consists of thinning 5 acres in Management Area 6 (Forest Stewardship Plan, by Lincoln Sherman, dated June 1995). This management area has a total of 10.1 acres. See attached drawing. No thinning has been done in this area in the recent past.

**SLASH DISPOSAL (BURNING)**  
FLEP-3, 7, 9 666-2

Project: The slash generated from the thinning operations in Management area 6 will be disposed of by burning and chipping. The dead decaying trees in the area will be piled up and burned as weather permits. It is estimated that 40 percent of the slash will be handled by burning

**SLASH DISPOSAL (CHIPPING)**  
FLEP 3, 7, 9 666-3

Project: The trees cut in Management Area 6 will be limbed and either harvested for lumber, or use as firewood. Slash lesser than 6" in diameter will be chipped and scattered. It is estimated that 60 percent of the slash generated in the 5 acres will be chipped.

WATER  
IMPOUNDMENT



WOODWORKING  
SHOP

STORAGE

EQUPT. STORAGE

POTTING ROOM

BUNKHOUSE AND STORAGE

HOME

11/21/05  
Kasper Lawson

SHRUBS / TREES TO BE REMOVED SHOWN  
NOT TO SCALE

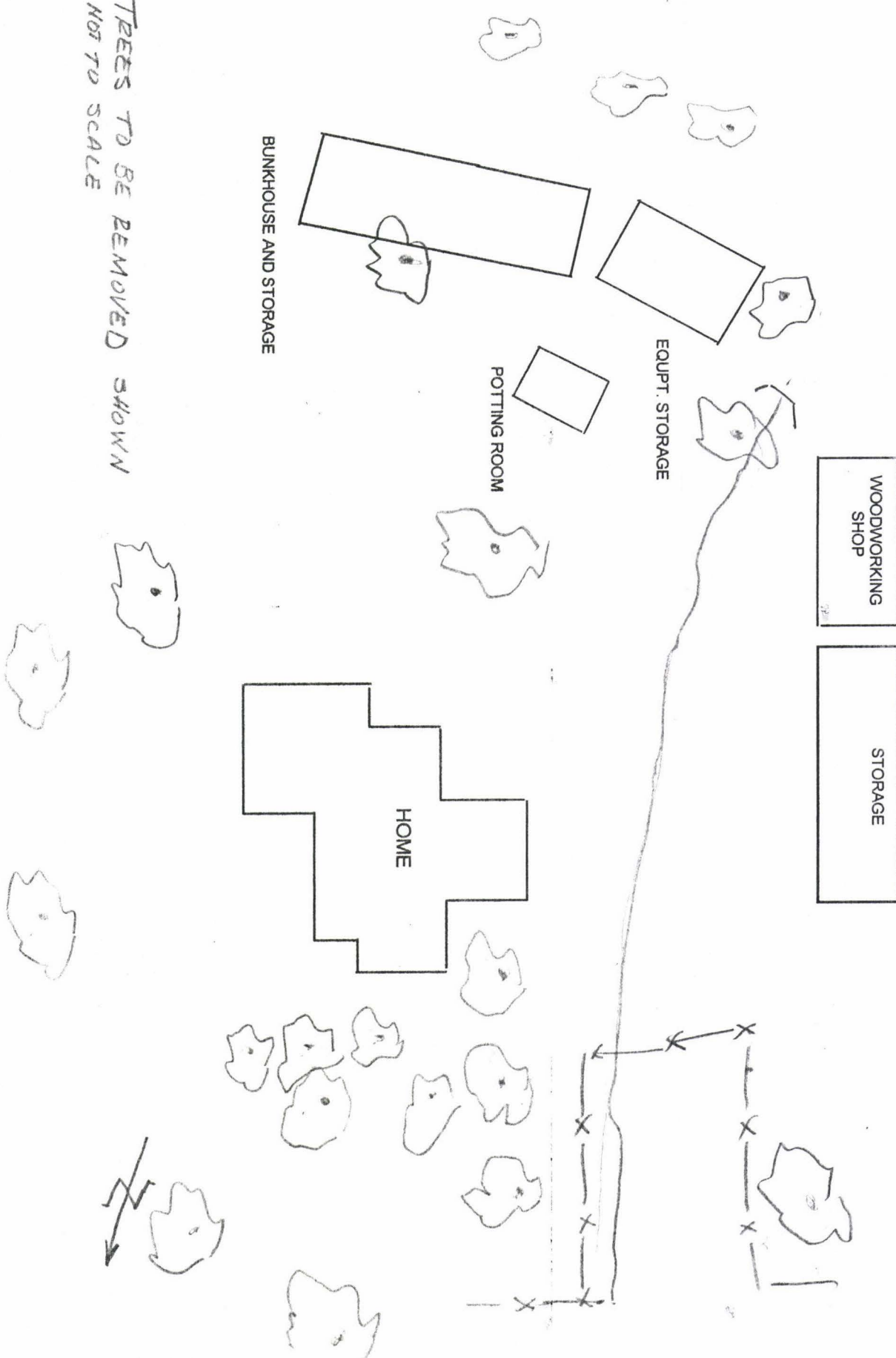

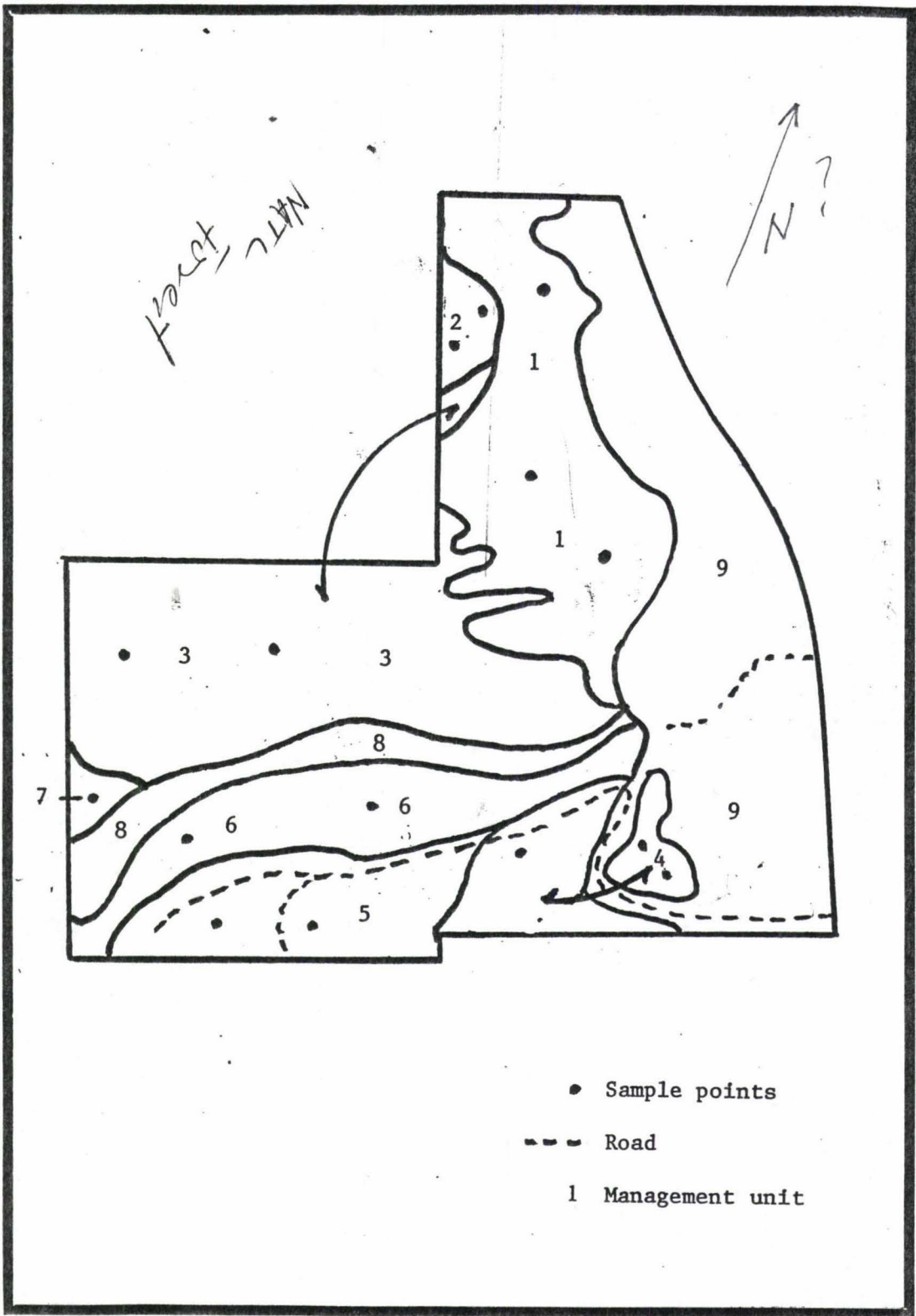

Figure 5.