

**WILDFIRE MITIGATION  
DEFENSIBLE SPACE ONLY**

This approval is not to be construed as to allow any violation of the Boulder County Building Code or the Boulder County Land Use Code.

Any field modifications must be approved by the Land Use Department prior to implementation.

Boulder County Land Use Department

*Curtis Reji* 1-2-02



*Knowledge to Go Places*

Boulder District  
5625 Ute Highway  
Longmont, Colorado 80503-9130  
(303) 823-5774

## WILDFIRE MITIGATION PLAN - SPR # 01-163

**Prepared for:**

Mr. and Mrs. Bach  
C/o Mr. Dominique Gettliffe  
2970 Washington St.  
Boulder, CO 80304

**Prepared by:**

Holly Asmus  
Forester  
Colorado State Forest Service  
[hasmus@lamar.colostate.edu](mailto:hasmus@lamar.colostate.edu)  
On December 20, 2001

*(Definitions are included on page 3.)*

### DESCRIPTION OF PROPERTY

The property is located at **337 Wildhorse Circle**, S23, T1N, R71W, in Pine Brook Hills, lot 96, Boulder County. The dominant fuel type is grass. The overstory is ponderosa pine. The property is on a southeast aspect with slopes of 15-40 %. Access to the property will be via a short driveway off of Wildhorse Circle. The property has a fairly open tree spacing. The portion of Wildhorse Circle below the property provides a fuel break that will complement the wildfire hazard mitigation work.

### RECOMMENDATIONS

The trees that are to be removed from the property have been marked with blue tree marking paint. The entire property is considered to be within the Zones 1 and 2 because the lot is one acre total.

As detailed in fact sheet 6.302, Creating wildfire defensible zones, enclosed, an important factor that determines a structure's ability to survive wildfire is defensible space. Defensible space is a maintained area around a structure where fuels (flammable materials) are modified to slow the possible spread of wildfire to the structure, as well as from the structure to the surrounding areas. Defensible space provides a place where structure protection and fire suppression operations may occur. Wildfire hazard mitigation work breaks up fuel continuity, potentially decreasing a wildfire's intensity, and for more effectiveness should be completed beyond a home's defensible space area.

There are three zones of protection to be created around the homesite for defensible space. Zone 1 is the most critical and affords the most protection to the site. Zones 2 and 3 are extensions of this protection.

### ZONE 1

Zone 1 starts at the foundation and extends out 15 feet in all directions. As per Boulder County Land Use Department, create a 3 foot wide strip of nonflammable groundcover immediately adjacent to the

structure. This can be accomplished by using decorative rock or gravel. This strip should surround the house and extend under any decks to 2 feet out past the drip line of the decks.

Thinning and pruning are necessary to create defensible space at the site. **All trees marked in blue should be removed.** Trees for removal were selected because of their poor form and/or lack of vigor in addition to their close spacing. Tree removal will improve the health of the remaining trees in addition to mitigating wildfire hazards.

Remove ladder fuels from beneath trees. Ladder fuels are small shrubs, trees, tree limbs, etc. that allow a fire to climb into a tree's crown. Limb trees to a height of ten feet on the remaining trees in this zone. For young, small trees in this zone, limb the lower third of the tree's height.

### ZONE 2

Zone 2 extends out from zone 1; it is a transition zone between the heavily thinned area near the house to a more traditional forest setting. In this zone, some clusters of trees are acceptable if there is adequate spacing between clusters. Poor quality, suppressed trees and saplings made up all of the removals.

At your site, zone 2 extends 65 feet in all directions (or to the edge of the property) from the outer edge of zone 1. In this zone, limb remaining trees to a height of eight feet from where zone 2 extends from the outer edge of zone 1 (15 feet from the structure). As you approach the outer edge of zone 2, reduce limbing height to six feet. Lower branches of young, small trees in this zone should be limbed to one third of the tree's height.

### ZONE 3

Zone 3 extends out from zone 2, and is of no set shape or size. At your site, zone 3 does extend into areas beyond your property boundaries. The following guidelines apply if you and your neighbors decide to work in these areas.

- Thin suppressed trees and trees with insect and disease infestations and retain the larger, healthier trees.
- Some slash in this zone could be lopped and scattered and/or piled for wildlife.
- Large amounts of slash should be disposed of by chipping, hauling to an approved site, or burning.
- For burning permits, check with your local fire protection district.

**All cutting, limbing and slash treatments must be completed prior to scheduling a C/O inspection. Contact me to set up an inspection date at least two weeks before you need the approval.**

Implementing this wildfire mitigation plan and maintaining your defensible space will help reduce the threat of wildfire to your home, but does not guarantee its safety.

In addition to the above recommendations, several other measures can be taken to make your home and family more prepared for and adapted to life in a fire prone ecosystem. While not required through Site Plan Review, other measures should be practiced by those who live in the wildland-urban interface. These include:

1. Be aware of fire danger. Signs are posted at the entrances of most major canyons.
2. Clean roof and gutters at least twice a year.
3. Stack firewood uphill at least 15 feet from buildings.
4. Do not store combustibles under decks.
5. Screen off foundations, roof and attic openings.
6. Screen and maintain spark arresters on chimneys.
7. When possible, maintain an irrigated greenbelt around the home.
8. Connect and have available at least 50 feet of garden hose during fire season.
9. Post lot and house numbers so that they are clearly visible.
10. Maintain the site's defensible space annually. Contact the Colorado State Forest Service for a 5 year maintenance inspection.

### DEFINITIONS

Aspect – Exposure. The direction a slope faces.

Canopy – The cover of branches and foliage formed collectively by crowns of adjacent trees.

Crown – Branches and foliage of a tree.

Dominant fuel type – Matter that would carry a fire, found on the ground.

Fuel continuity – The proximity of fuels to each other. Helps determine if a fire can sustain itself.

Limb (verb) – To remove the branches from a tree.

Overstory – The tree species that forms the uppermost forest layer.

Wildfire mitigation plan – A plan to reduce wildfire hazards around a home or other structure through fuels reduction and landowner awareness.



*Knowledge to Go Places*

Boulder District  
5625 Ute Highway  
Longmont, Colorado 80503-9130  
(303) 823-5774

September 23, 2003

Eric Phillips  
Boulder County Land Use Dept.  
P.O. Box 471  
Boulder, CO 80306

Dear Eric,

This letter is to inform you that Mr. Bach, SPR# 01-163, has completed his fire mitigation work on his property located at 337 Wildhorse Circle, Boulder, CO 80302. The Colorado State Forest Service has inspected Mr. Bach work accomplishment on August 7, 2003 and is satisfied with the results.

If you have any questions please contact us at 303-823-5774 or by email at [csecher@lamar.colostate.edu](mailto:csecher@lamar.colostate.edu).

Sincerely,



Cory Secher  
Forester

September 23, 2003

Mr. Bach  
2970 Washington St.  
Boulder, CO 80304

Docket Number: 01-163

Dear Mr. Bach,

This letter is to notify you that the inspection of your wildfire mitigation around your property located at 337 Wildhorse Circle, Boulder, CO 80302, for your Site Plan Review requirements were satisfactory. A letter has been sent to County Land Use Department informing them of our completed inspection. Please contact County Land Use Department at 303-441-3930 for the next step in this process.

If you have any questions please contact me at 303-823-5774 or by email at [csecher@lamar.colostate.edu](mailto:csecher@lamar.colostate.edu).

Sincerely,

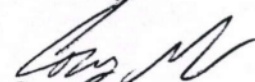
  
Cory Secher  
Forester

December 20, 2001

Eric Philips  
Boulder County Land Use Department  
P.O. Box 471  
Boulder, CO 80306

Hi Eric,

Enclosed is a copy of SPR # 01-163. It has been marked, but I have not received payment and I have not inspected the property. It was marked on December 20, 2001. Enclosed is a copy of the letter I sent to Getliffe Architecture as well. Apparently, he has sent you a site map.

If you have any questions, please feel free to contact me.

Happy Holidays!

Sincerely,

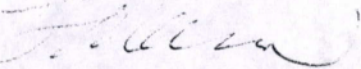

Holly Asmus  
Forester



*Knowledge to Go Places*

Boulder District  
5625 Ute Highway  
Longmont, Colorado 80503-9130  
(303) 823-5774

December 20, 2001

Dominique Getliffe  
2970 Washington St.  
Boulder, CO 80304

Dear Mr. Getliffe,

I hope all is well. Enclosed is a copy of your Wildfire Mitigation Site Plan Review.

As soon as I receive payment for the plan and complete the inspection, I will submit your plan to Boulder County Land Use. If you have any further questions about the SPR process or concerns about forest management issues, please feel free to contact me.

Enjoy the holiday season.

Sincerely,

A handwritten signature in black ink, appearing to read "Holly Asmus". The signature is fluid and cursive, with a long horizontal stroke at the end.

Holly Asmus  
Forester

SPR MITIGATION PLAN FORM

Send to Eric by Friday

TODAY'S DATE: 12/18/01

LANDOWNER'S NAME: Bach

MAILING ADDRESS: \_\_\_\_\_

SITE ADDRESS: 337 Wildhorse Circle PINEBROOK HILLS 2  
lot 96

SPR# 01-163 SECTION 23 TOWNSHIP 1N RANGE 71W

DOMINANT FUEL TYPE shrub/grasses OVERSTORY PP

ASPECT SE SLOPE \_\_\_\_\_ % TOTAL ACERAGE \_\_\_\_\_

FUEL MODEL \_\_\_\_\_

I&D/FOREST HEALTH \_\_\_\_\_

SITE MAP INCLUDED? Y  N County has site map

VISIBLE SIGNAGE?  Y  N

DRIVEWAY (length, width, location) \_\_\_\_\_ ROAD ACCESS 1 acres

BUILDING/STRUCTURE: MATERIALS \_\_\_\_\_  
SQ. FT. \_\_\_\_\_  
HEIGHT/STORIES \_\_\_\_\_  
DECK \_\_\_\_\_  
ROOFING \_\_\_\_\_ WINDOWS \_\_\_\_\_  
LEECH FIELD \_\_\_\_\_  
CISTERN (capacity) \_\_\_\_\_  
PROPANE \_\_\_\_\_

FPD \_\_\_\_\_

COMMENTS/RECOMMENDATIONS:

Russian Olive ?

Eric, Dominique has said you has a detailed map.



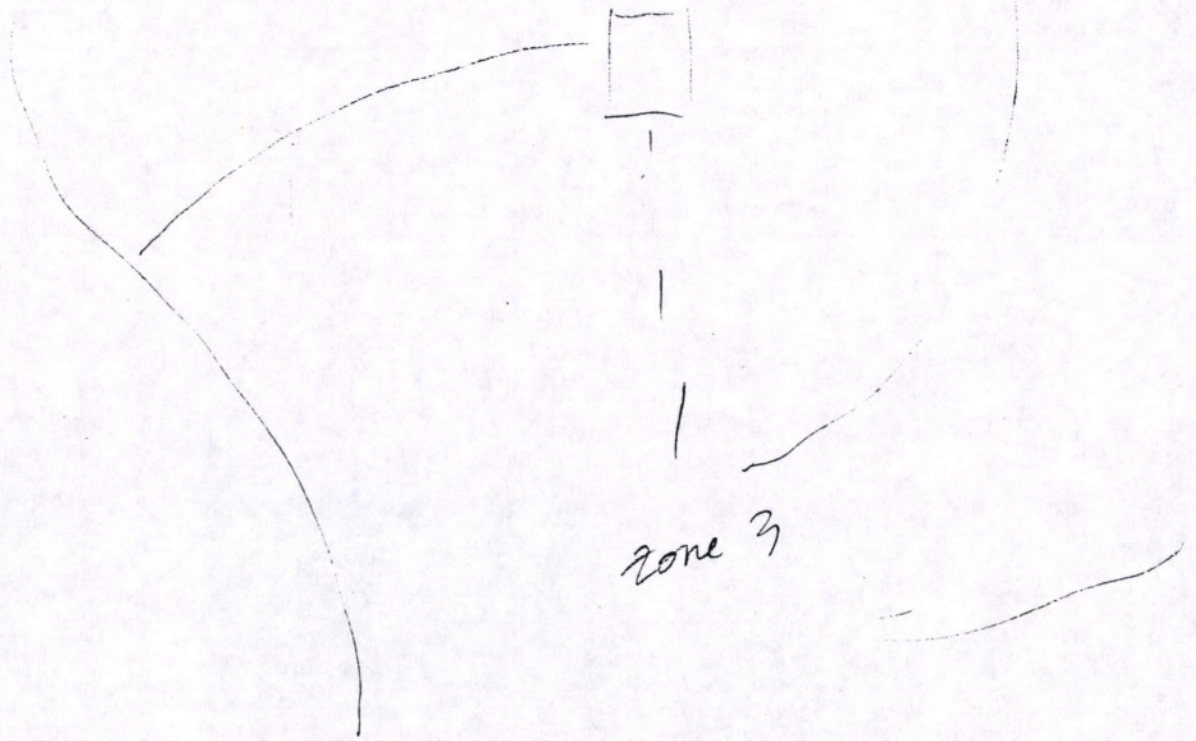

# GETTLIFFE ARCHITECTURE

Environmental Design  
Construction,  
& Planning

Dominique Gettliffe, A.L.A.

2970 Washington Street  
Boulder, Colorado 80304  
Tel. 303 449-9155  
Fax 303 402-9007

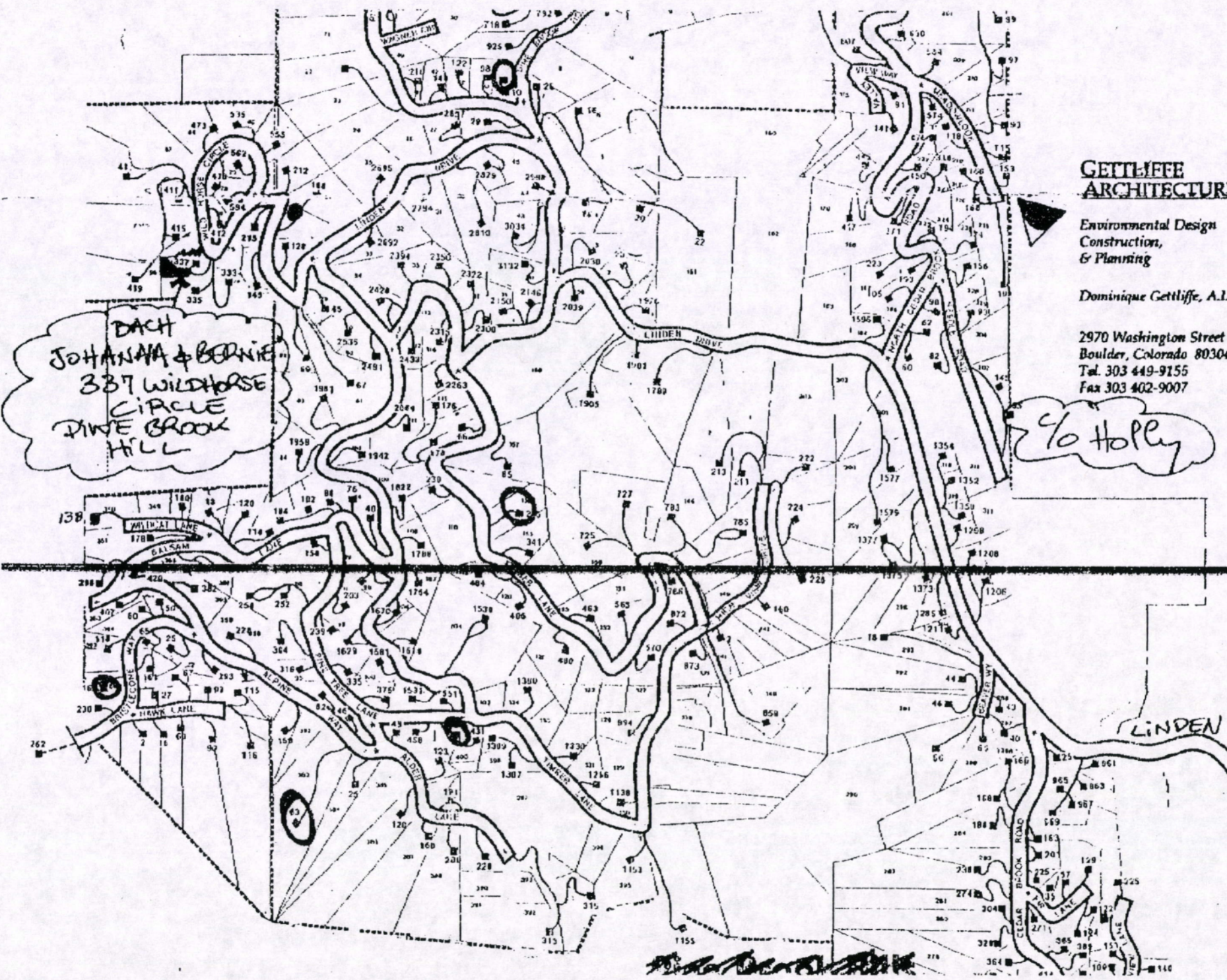

DACH  
JOHANNA & BERNIE  
387 WILDHORSE  
CIRCLE  
PINE BROOK  
HILL

% Holly