



COLORADO'S
FLEP FOREST LAND
 ENHANCEMENT PROGRAM
 APPLICATION FOR COST-SHARE

PROJECT NUMBER: _____
 (For Official Use Only)

NAME: GLENN SNYDER
 MAILING ADDRESS: 1223 SOUTH JOHNSON WAY
 City: LAKEWOOD State: CO
 Zipcode: 80232
 TELEPHONE NO: 720 939 9458

PROJECT ADDRESS/LEGAL DESCRIPTION: 309 RASPBERRY LANE
T12N, R72W 526 SE 1/4 SE 1/4

PRACTICES TO BE COMPLETED BY: _____

Practice No. & Component Title	Quantity Requested	Quantity Approved	Maximum C/S Amount	C/S Amount Requested	C/S Amount Approved
9/666-6 FSI FUEL BREAK	2 ACRES		2400	2400	
3,4,7,9/ 660 PRUNE	2 ACRES		150	150	
3,7,9/ 666-3 CHIP	1 ACRE		300	300	
3,7,9/ 666-4 HAUL	1 ACRE		300	300	

Total: 3150

Request for cost-share assistance under this program is to meet the objective stated in the management plan. If cost-sharing is approved for the practice requested, I agree to cover expenses at the time of implementation, knowing I will be receiving cost-share funds not exceeding 50% of actual cost. **I understand that I will not be reimbursed for any expenses incurred prior to approval of my application.** Work must be completed according to approved plan and application, and must meet the standard set for each component. Practices must be maintained for a minimum of 10 years. There are no partial payments.

LANDOWNER SIGNATURE: Glenn Snyder DATE: 6/13/05

CSFS FIELD REVIEW SIGNATURE: _____ DATE: _____
 (Additional USFWS guidelines addressed)

C/S APPROVED: M. J. Ayres AMOUNT: \$ 600 DATE: _____

Program eligibility is without regard to race, color, religion, national origin, age, gender, sexual orientation, veteran status or disability. For more information contact your local Colorado State Forest Service District Office.

FOREST LAND ENHANCEMENT PROGRAM PLAN DESIGN

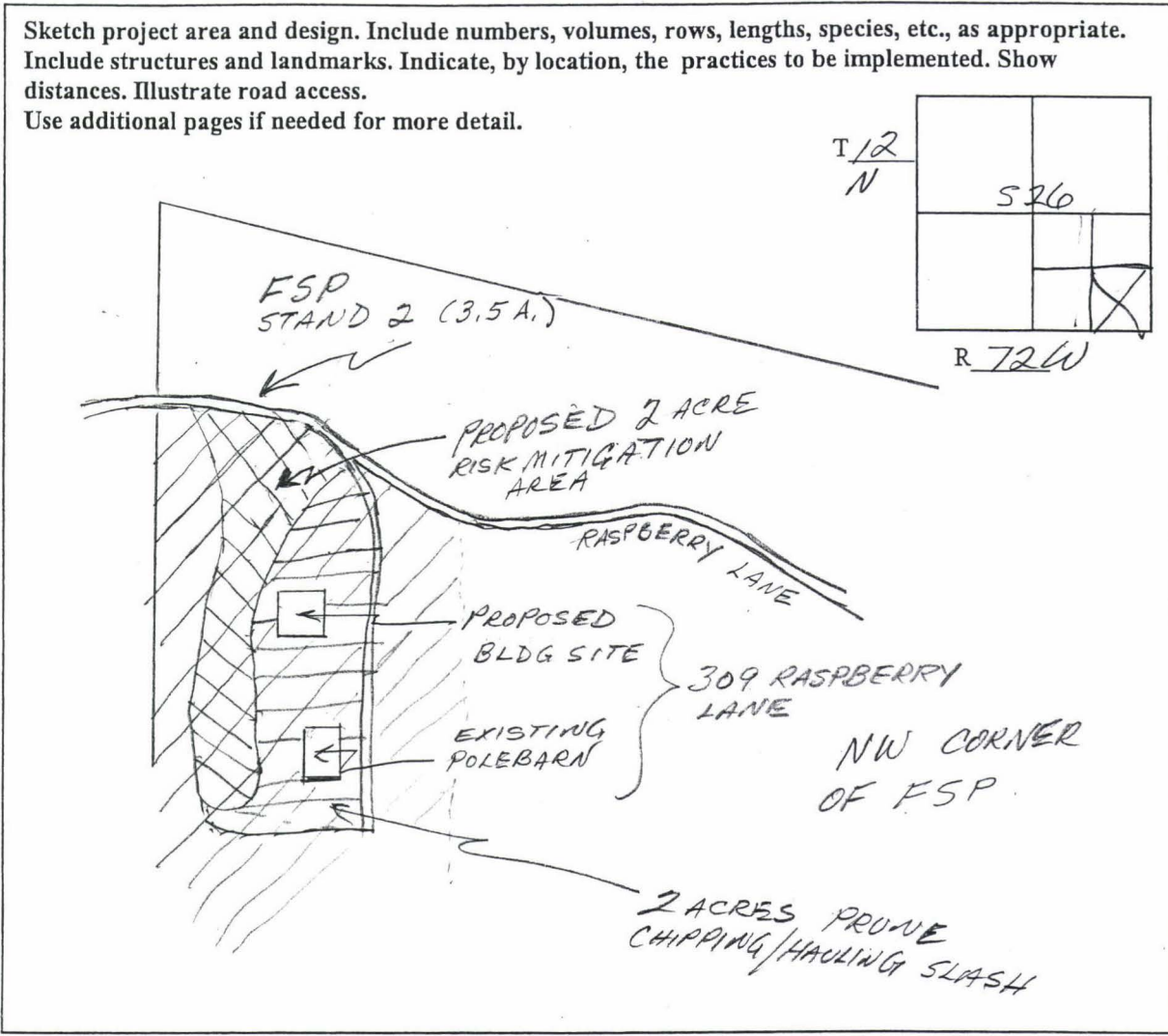





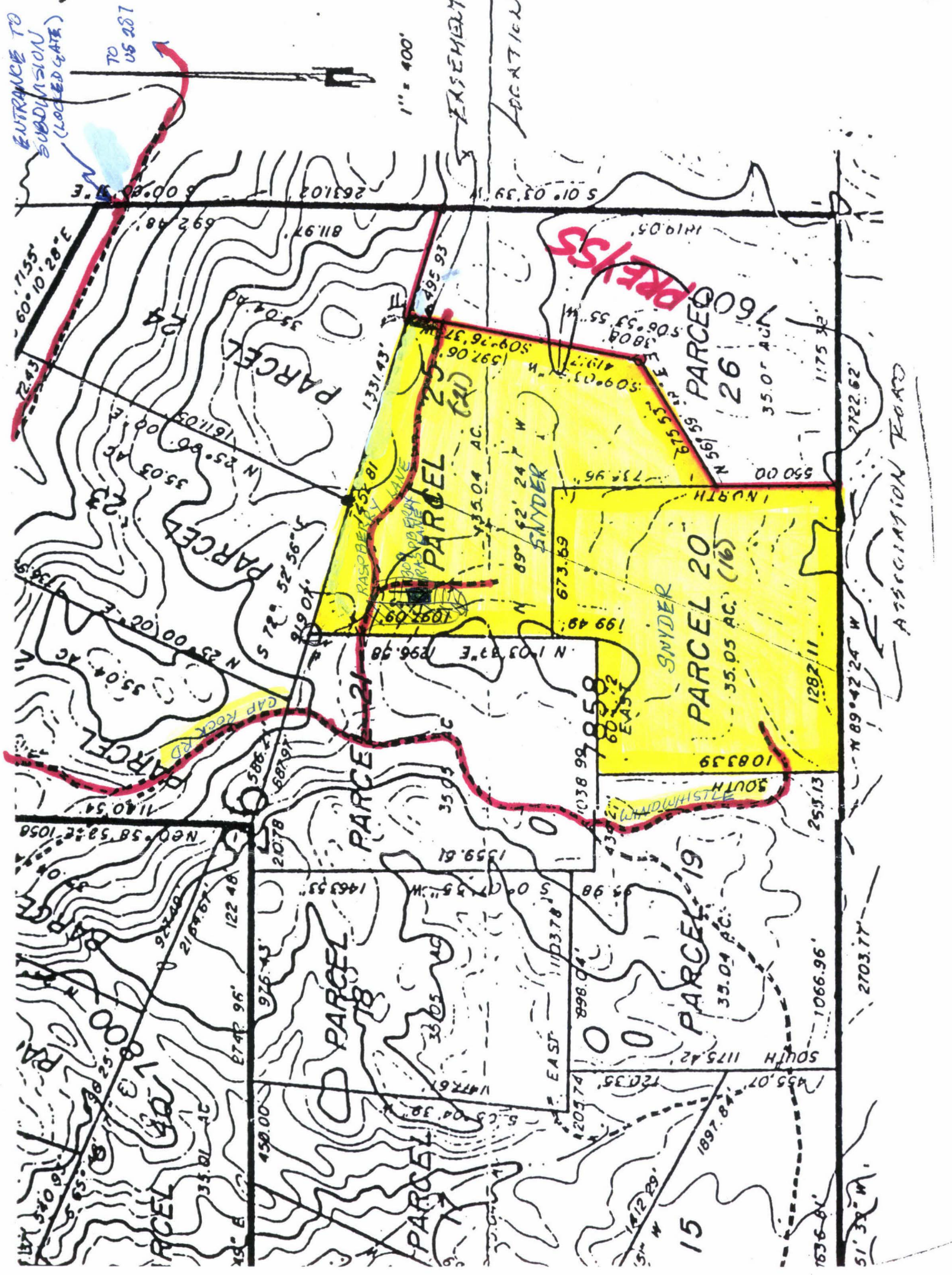



LIST PRACTICE AND COMPONENTS WITH IMPLEMENTATION SCHEDULE:

PRACTICE/COMPONENT/OTHER SPECIFICATIONS	COMPLETION DATE
FLEP 9 660-6 TWO ACRE FOREST STAND IMP. BY THINNING/WOOD UTILIZATION/SLASH & WOODY DEBRIS REMOVAL FOR FUEL BREAK	12/31/05
FLEP 3,7,9 660-3 + 660-4 TWO ACRES CHIPPING HAULING SLASH	12/31/05
FLEP 3,4,7,9 660 PRUNE TWO ACRES	12/31/05



Map Legend

Management stands

- | | | | |
|---|---------|---|-----------------|
|  | Stand 1 |  | Stand 5 |
|  | Stand 2 |  | Recorded corner |
|  | Stand 3 |  | Mpb located |
|  | Stand 4 |  | Road |

Map 4: management stands

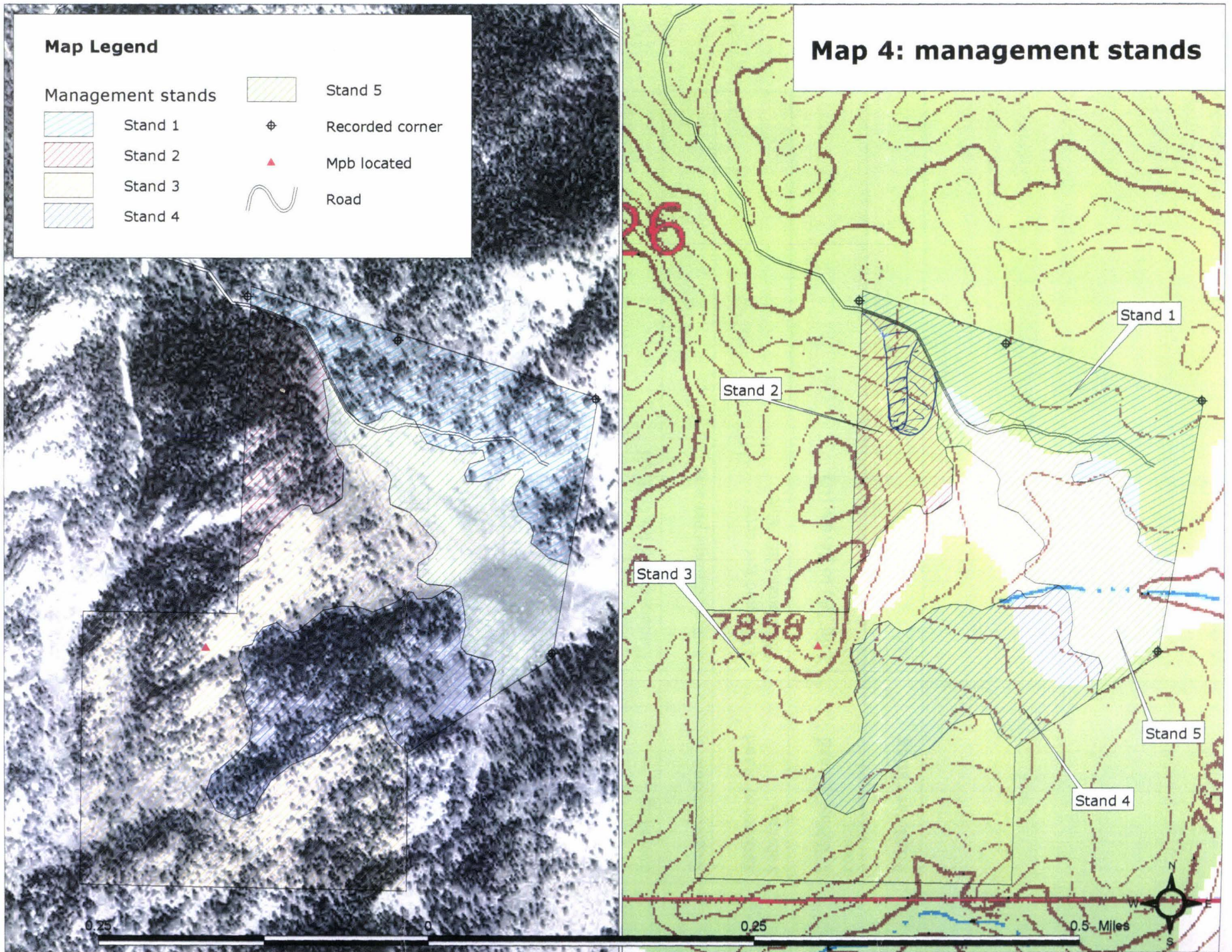







Map 3: wildfire hazards

Map Legend

-  Snyder property
-  Road
-  Recorded corner

Wildfire hazards (private)

-  High-shrub
-  High-timber
-  Moderate
-  Low
-  Lowest
-  National Forest

