

FAX TRANSMITTAL TO: Holly Asmus

<3 pages>

FAX#: 303-448-1283

From: Larry Knecht (FAX #: 303-444-1759)

re: site visit

July 5, 2001

Confirmation of the scheduled meeting at our lot on Monday, July 9th at 9:00 a.m. in Nederland and directions. . .

DIRECTIONS TO LOT 14, INDIAN PEAKS SUBDIVISION - NEDERLAND

LARRY & SANDRA KNECHT

In addition to this written description, I have provided a map. Hopefully, between the two, you will have no difficulty finding your way. If you have any question, please call me at either my work number:

303-444-4413

or my home number (after 6pm):

303-499-2277 . . .

Take Boulder Canyon (CO Hwy 119) to Nederland. At the "roundabout" bear West, heading up The "Peak to Peak" Hwy (CO 72) North, to just outside of town. At the crest of the hill, you will see a sign that says "Elementary School" with a paved road off to the left, *just beyond* that sign. Follow that road, winding generally SW, until you see an unimproved dirt road to the right, just before a pedestrian crosswalk sign. Follow that road to the first left turn and take it. You will see what appears to be a road/path that heads south through the woods to the elementary school (barely visible). Our lot borders the right of this track and extends to just beyond a red fire hydrant and a green transformer. Look for a black Acura Integra sedan (License # MY-8103) which will be mine. Hopefully, I'll be there before you in the morning, barring any unforeseen difficulties.

Looking forward to meeting you,

Larry

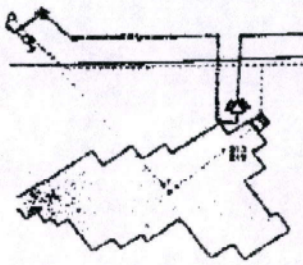
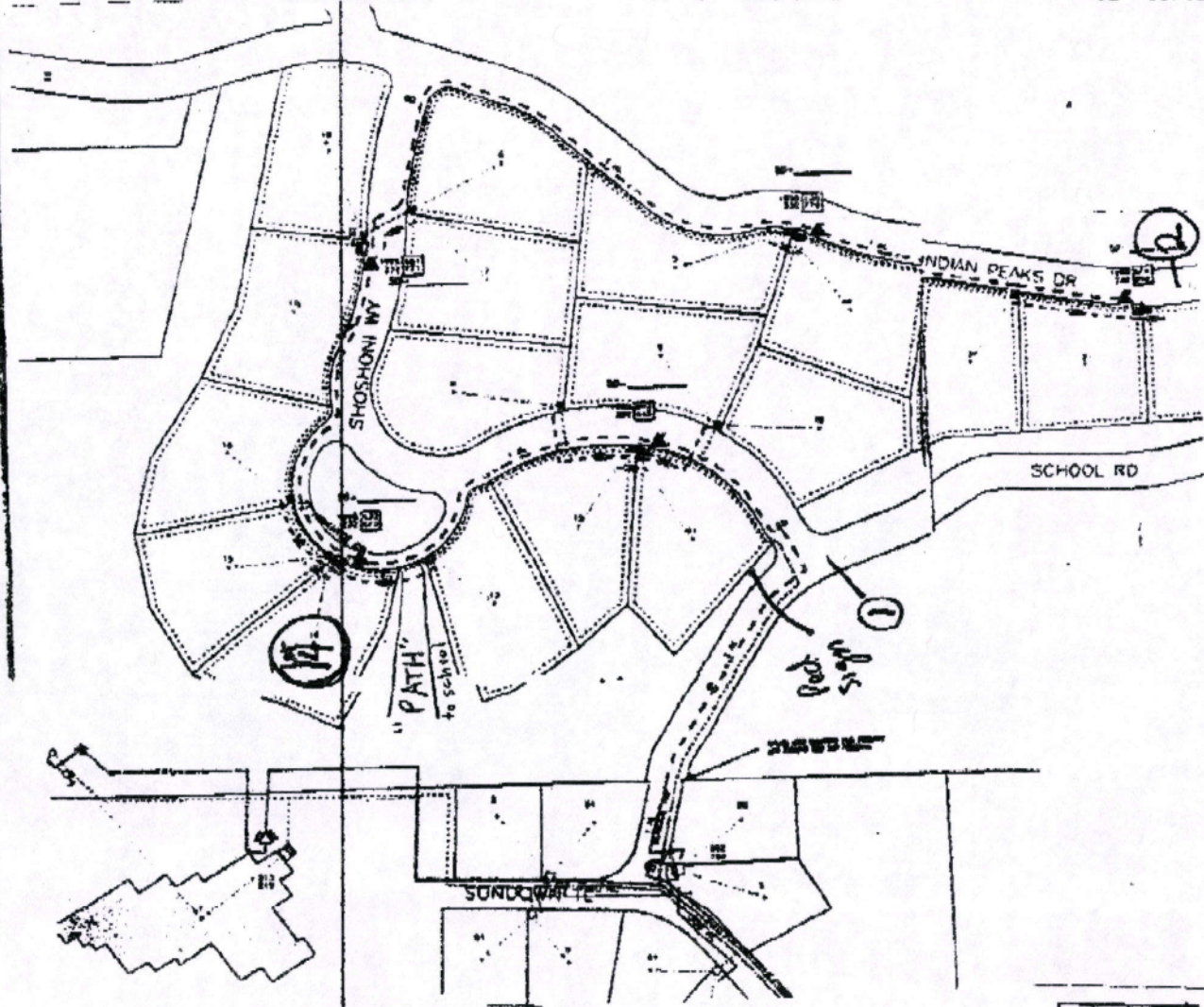

SITE MAP



INSTALL

- 3 - TRANSFORMER PAD 48" X 62"
- 11 - PEDESTAL FOR ONE UP/NOV
- 1000' - CONDUIT (3/4" DIA) TRIPLEX 1/2"
- 3000' - CONDUIT (1" DIA) 3/4" ALUMINUM 1-C

SET:

- 5 - TRANSFORMERS 30KVA 14.1KV 120V 1PH/3
- 720' - TRENCH & BACKFILL (95% COMPACTION)
- 2720' - TRENCH & BACKFILL (80% COMPACTION)

ATTEND PRIMARY TO SERVE NEW 10 LOT SUBDIVISION

JOINT TRENCH

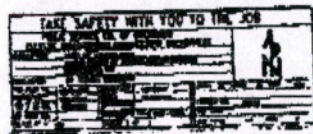

Postpaid Fax Note	7671	Date	4/5/01	Pages	1
City/State	Alaska	From	Shirley Gates		
Phone #	303 258 3246	Co.	Shirley Gates		
Fax #	303 258 1759	Phone #	303 258 3246		
		Fax #	303 258 1759		

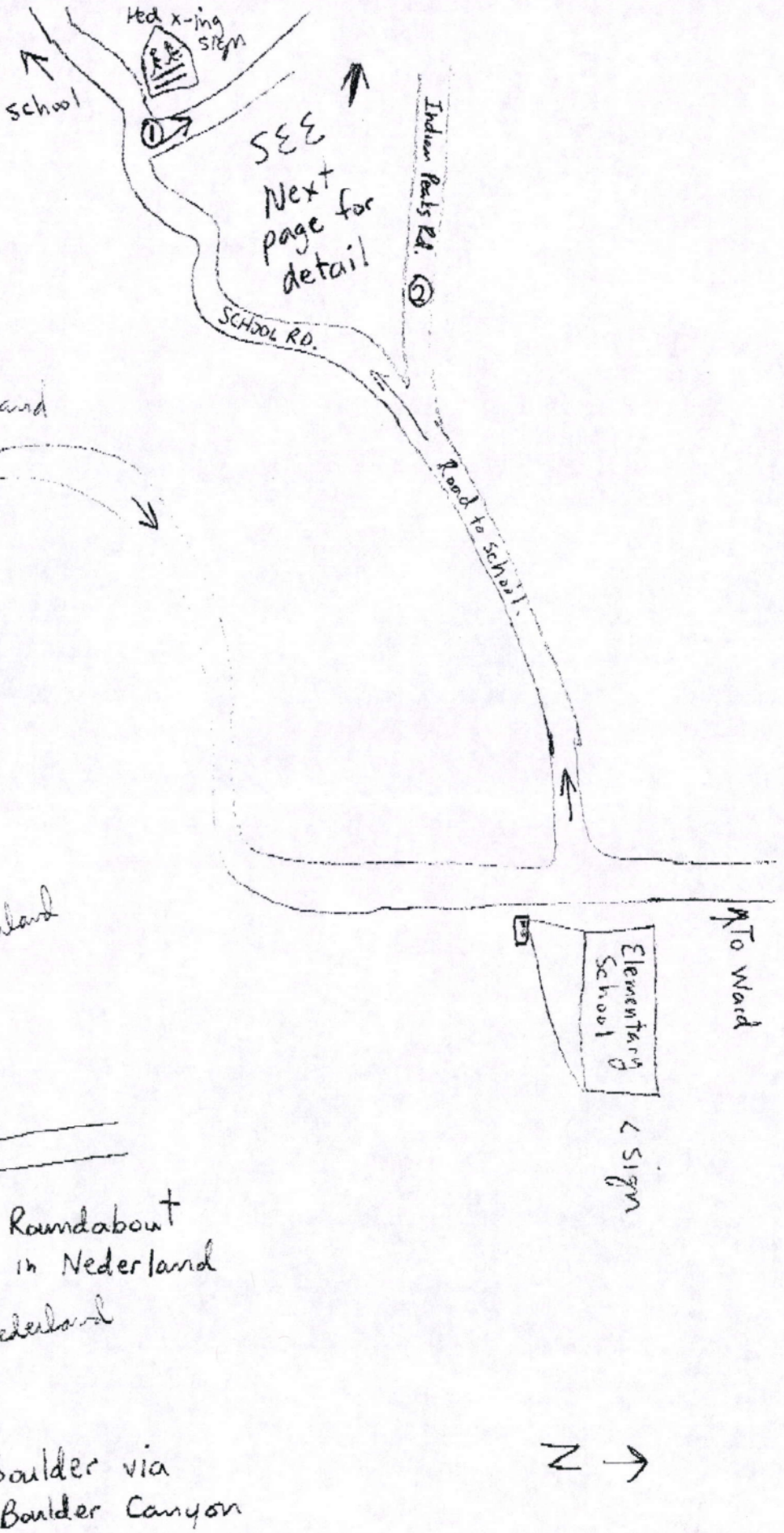

not to scale

N →

18 homes

house not staked

SPR MITIGATION PLAN FORM

7/9/01

1 acre 3 structures
garage
guest house

TODAY'S DATE: _____
LANDOWNER'S NAME: Larry Knecht
MAILING ADDRESS: 605 S. 41st
Boulder, CO 80305

SITE ADDRESS: Lot 14 Indian Peaks Subdivision

SPR# 01-005 SECTION _____ TOWNSHIP _____ RANGE _____

DOMINANT FUEL TYPE _____ OVERSTORY _____

ASPECT 5% - 10% SLOPE 5% - 10% % TOTAL ACERAGE _____

FUEL MODEL _____

I&D/FOREST HEALTH _____

SITE MAP INCLUDED? Y N

VISIBLE SIGNAGE? Y N

DRIVEWAY (length, width, location) _____ ROAD ACCESS _____

BUILDING/STRUCTURE: MATERIALS OK
SQ. FT. 1000-2000 3 Bldg.
HEIGHT/STORIES _____
DECK wood deck
ROOFING OK WINDOWS _____
LEECH FIELD NO
CISTERN (capacity) _____
PROPANE _____

FPD _____

COMMENTS/RECOMMENDATIONS:

