

CSFS Copy

S E R V I C E A G R E E M E N T
T O T A L T R E E C A R E

THIS AGREEMENT, made this 7th day of April, 1994 by and between Bruce Victor, who resides at 6071 W. 76th Avenue, Westminster, CO 80003, hereinafter referred to as the LANDOWNER, and the State Board of Agriculture, in behalf of the Colorado State Forest Service, Boulder District, 936 Lefthand Canyon Drive, Boulder, CO 80302 (442-0428), hereinafter referred to as the FOREST SERVICE; and

WHEREAS, the FOREST SERVICE has the expertise to provide forest practice services; and

WHEREAS, the LANDOWNER desires to implement forest practices described in this Agreement.

NOW, THEREFORE, it is hereby agreed that:

1. LANDOWNER warrants that he/she is the owner of the property described as follows, or has obtained authority from the owner of said property to grant all rights to the FOREST SERVICE provided for in this Agreement. The owner's property is located on Weld County Road 31/20, approximately six miles northeast of Ft. Lupton in Weld County.

2. LANDOWNER grants to FOREST SERVICE the right of access to the above described property for the following purposes: To implement the Total Tree Care Planting Project as described and shown in Appendix A.

3. FOREST SERVICE agrees to provide the services specified in Paragraph 2 of this Agreement in consideration for: A total lump sum of \$4000. \$2000 due upon signing of the contract and \$2000 due upon completion of the project. Any additional activities required or requested to be implemented only after negotiation of reasonable compensation. **NOTE: Final bill to be reduced if "optional if by owner" activities are conducted by landowner.**

4. It is understood between the LANDOWNER and the FOREST SERVICE that this Agreement shall begin on the date first above written, and shall remain in force until June 30, 1994.

5. This Agreement may be terminated by either party ten (10) days following written notice to the other party.

6. FOREST SERVICE may assign the rights provided for in this Agreement to a subcontractor of its choice without obtaining the approval of the LANDOWNER,

857-6199

16435 WCR 18
Ft. Lupton

80621

7. The Colorado State Forest Service shall maintain during the life of this Agreement such liability insurance as is required by Colorado law.

8. This Agreement shall be extended due to inability of the FOREST SERVICE to perform the work due to circumstances beyond its control or as mutually agreed to by the LANDOWNER and FOREST SERVICE. All extensions will be written and become a part of this Agreement.

9. Financial obligations of FOREST SERVICE payable after the current fiscal year are contingent upon funds for that purpose being appropriated, budgeted and otherwise made available.

10. The FOREST SERVICE agrees as part of this Agreement that it will comply with all applicable laws regarding discrimination on the basis of race, creed, color, sex, or handicap including but not limited to Executive Order 11246 as amended or as may be further amended hereafter.

11. The laws of the state of Colorado and rules and regulations issued pursuant thereto shall be applied in the interpretation, execution and enforcement of this Agreement.

12. The signatories hereto aver that they are familiar with 18-8-301, et. seq., (Bribery and Corrupt Influences) and 18-8-401, et. seq., (Abuse of Public Office), C.R.S. 1973, as amended, and that no violation of such provision is present.

13. The signatories aver that to their knowledge no FOREST SERVICE employee has any personal or beneficial interest whatsoever in the services or property described herein.

IN WITNESS WHEREOF the parties hereto have executed this Agreement on the day first above written.

Bruce Victor
LANDOWNER

4/18/94
DATE

[Signature]
FORESTER
COLORADO STATE FOREST SERVICE

4/11/94
DATE

File Code: WOOD-22

WINDBREAK PLANTING AND PLAN RECORD

U.S. DEPARTMENT OF AGRICULTURE
Soil Conservation Service

OPERATOR Bruce Victor

ADDRESS 6011 W. 116th Ave.
Westminster, Co. 80033

Year Planted 1994

SEC. E 1/2 23 TWP. 2n RGE. 10w1 COUNTY Weld

SOIL CONSERVATION DISTRICT Platte Valley

TYPE OF PLANTING:

Field Windbreak

Windbreak Group 5

PLANNED WEED CONTROL

Mechanical	
Chemical	(a) lbs/acre

PLANNED METHOD & YEAR OF PLANTING

	Dist.	Farmer	Date
Machine		✓	11-94
Hand			

AREA PLANTED:

Field #	Width	Length	Sq. Ft.	Acres
1				2.4

PLANNED COMPOSITION

ROW #1 is always on north or west side of planting

PLANNED GROUND PREPARATION:

Prepare 37' wide Strip/monitored Disturbance

SKETCH OF PLANTING

Location in Section

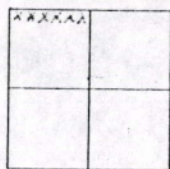
$$\approx 2.640$$

WCR 20

112 822

PROPOSED SPECIES

Planned By.

Date _____

CERTIFICATION:

Directions on back

Signature: _____

District Conservationist

WINDBREAK PLANTING AND PLAN RECORD

U.S. DEPARTMENT OF AGRICULTURE
Soil Conservation ServiceOPERATOR Bruce VictorADDRESS 6071 W. 76th Ave.
Westminster, Co. 80003Year Planted 1994SEC. E/223 TWP. 2n RGE. 66W COUNTY WeldSOIL CONSERVATION DISTRICT Platte Valley

TYPE OF PLANTING:

Field WindbreakWindbreak Group 5

AREA PLANTED:

Field #	Width	Length	Sq. Ft.	Acres
<u>1</u>				<u>2.4</u>

PLANNED WEED CONTROL

Mechanical	<input checked="" type="checkbox"/>		
Chemical		@	Lbs/acre

PLANNED METHOD & YEAR OF PLANTING

	Dist.	Farmer	Date
Machine		<input checked="" type="checkbox"/>	<u>4-94</u>
Hand			

PLANNED COMPOSITION

ROW #1 is always on north or west side of planting

PLANNED GROUND PREPARATION:

Prepare 371' wide Strip/ minimal Disturbance

SKETCH OF PLANTING

Location in Section

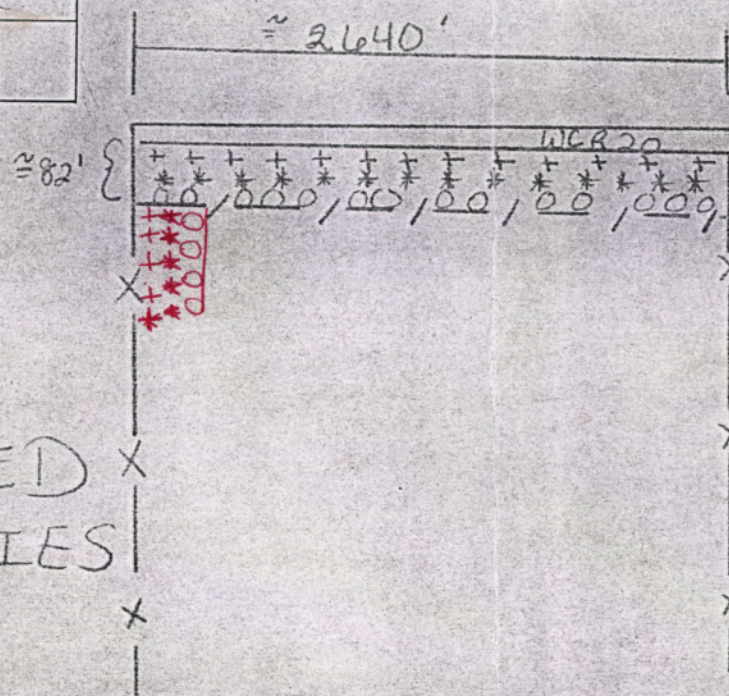
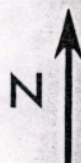
REVISED
SPECIES

Row No.	SPECIES	Spacing in Row	Spacing Between Rows	Est. Number of Trees Needed	A Nu of Trees Planted
<u>1</u>	<u>Nanking Cherry</u>	<u>5</u>	<u>16</u>	<u>528</u>	<u>550</u>
<u>2</u>	<u>Hackberry</u>	<u>12</u>	<u>16</u>	<u>220</u>	<u>550</u>
<u>3</u>	<u>Rocky mt. Juniper</u>	<u>10</u>		<u>264</u>	<u>270</u>

Total Number of Trees by Species:

<u>Nanking Cherry</u>	<u>528</u>	<u>550</u>
<u>Hackberry</u>	<u>220</u>	<u>550</u>
<u>Rocky mt. Juniper</u>	<u>264</u>	<u>270</u>

CERTIFICATION:

Directions on backPlanned By B. VictorDate Feb 28, 1994Signature: Sylvia A. Gullen

District Conservationist

take Hwy. 52 east to hwy 85. Go North on hwy 85
3 miles to Rd. 20. Go east on Rd. 20 for 2 miles -
to WCR 31. Keep going east on Rd. 20 for 1 more
mile. You have reached the west edge of the
windbreak planting. It is on the South side
of Rd. 20.

SOIL MAP

Owner BRUCE VICTOR Operator SAME
County WELD State COLORADO
Soil survey sheet(s) or code nos. 22, 23, 30, 31 Approximate scale 3 1/2" = 1 MILE
Prepared by U. S. Department of Agriculture, Soil Conservation Service cooperating
with PLATTE VALLEY SOIL Conservation District

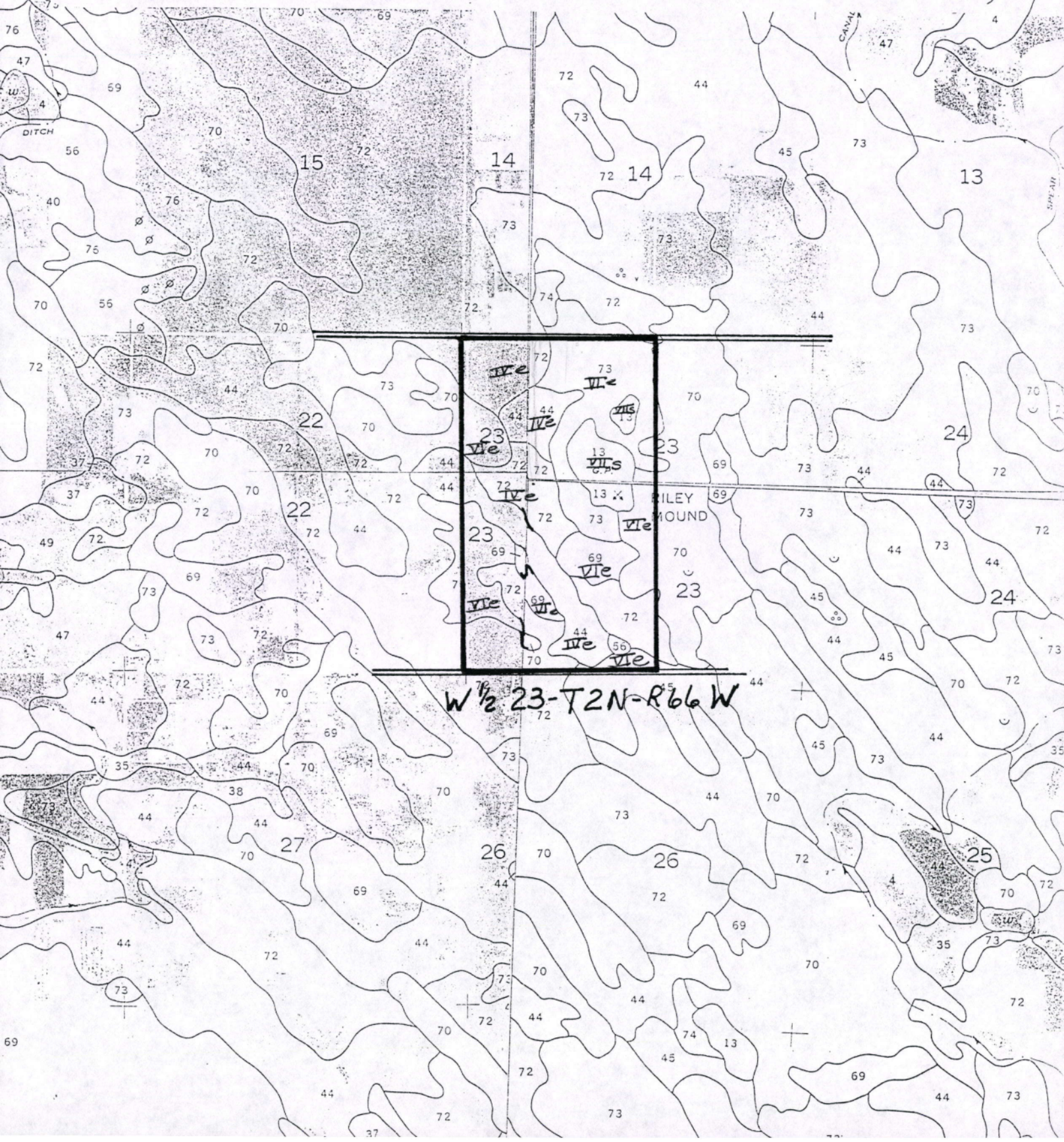

SOIL DESCRIPTION REPORT

SURVEY AREA - WELD COUNTY SO. PART

Map Unit

Symbol Description

- 13 CASCAJO GRAVELLY SANDY LOAM, 5 TO 20 PERCENT SLOPES
The Cascajo soil is a deep, excessively drained soil. It is formed on terrace edges and upland ridges from very gravelly calcareous alluvial material. The surface is a sandy loam. The underlying material is a very gravelly sandy loam and very gravelly sand. The soils have moderately rapid permeability. Their available water holding capacity is moderate. Roots penetrate to 60 inches or more. Runoff is slow to medium and the erosion hazard due to wind is severe. Capability subclass VIIs nonirrigated.
- 44 OLNEY LOAMY SAND, 1 TO 3 PERCENT SLOPES
The Olney soil is a deep, well drained soil. It is formed on smooth plains in mixed outwash deposits. The surface is a loamy sand. The subsoil is a sandy clay loam. The underlying material is a calcareous fine sandy loam. The soils have moderate permeability. Their available water holding capacity is moderate. Roots penetrate to 60 inches or more. Runoff is slow and the erosion hazard due to wind is high. Capability subclass IIIe irrigated, IVe nonirrigated.
- 56 RENOHILL CLAY LOAM, 0 TO 3 PERCENT SLOPES
The Renohill soil is a moderately deep, well drained soil. It is formed on plains in residuum from shale. The surface is a clay loam as are the subsoil and the underlying material. The soils have slow permeability. Their available water holding capacity is moderate. Roots penetrate to the depth of the shale, which ranges from 20 to 40 inches. Runoff is medium and the erosion hazard due to wind is moderate. Capability subclass IIIs irrigated, IVe nonirrigated.
- 69 VALENT SAND, 0 TO 3 PERCENT SLOPES
The Valent soil is a deep, excessively drained soil. It is formed on plains from eolian material. The surface is a sand, as is the underlying material. The soils have rapid permeability. Their available water holding capacity is moderate. Roots penetrate to 60 inches or more. Runoff is slow and the erosion hazard due to wind is high. Capability subclass IVe irrigated, VIe nonirrigated.
- 70 VALENT SAND, 3 TO 9 PERCENT SLOPES

SOIL DESCRIPTION REPORT

SURVEY AREA - WELD COUNTY SO.PART

Map Unit

Symbol Description

The Valent soil is a deep, excessively drained soil. It is formed on plains from eolian material. The surface is a sand, as is the underlying material. The soils have rapid permeability. Their available water holding capacity is moderate. Roots penetrate to 60 inches or more. Runoff is slow and the erosion hazard due to wind is high. Capability subclass VIe irrigated, VIe nonirrigated.

72

VONA LOAMY SAND, 0 TO 3 PERCENT SLOPES

The Vona soil is a deep, somewhat excessively drained soil. It is formed on plains and high terraces in eolian or alluvial deposits. The surface is a fine sandy loam, as is the subsoil. The underlying material is a sandy loam. The soils have moderately rapid permeability. Their available water holding capacity is moderate. Roots penetrate to 60 inches or more. Runoff is slow and the erosion hazard due to wind is high. Capability subclass IIIe irrigated, IVe nonirrigated.

73

VONA LOAMY SAND, 3 TO 5 PERCENT SLOPES

The Vona soil is a deep, somewhat excessively drained soil. It is formed on plains and high terraces in eolian or alluvial deposits. The surface is a fine sandy loam, as is the subsoil. The underlying material is a sandy loam. The soils have moderately rapid permeability. Their available water holding capacity is moderate. Roots penetrate to 60 inches or more. Runoff is slow and the erosion hazard due to wind is high. Capability subclass IVe irrigated, VIe nonirrigated.

Category Codes: soi

Row 1 American plan

Row 2 Russian-drive

Row 3 Hackberry/Cottonwood

Row 4 Ponderosa pine

Row 5 RMJ

200' long

west of drive.

loamy
Vona, sand

mangrove & trees