



COLORADO'S
FLEP FOREST LAND
 ENHANCEMENT PROGRAM
 APPLICATION FOR COST-SHARE

PROJECT NUMBER: _____
 (For Official Use Only)

NAME: STEVEN A. GOODROAD
 MAILING ADDRESS: 4024 BOULDER DRIVE
 City: LOVELAND State: CO
 Zipcode: 80538
 TELEPHONE NO: 970 669-1238

PROJECT ADDRESS/LEGAL DESCRIPTION: 1854 QUILLAN GULCH ROAD
LOVELAND, CO 80537

PRACTICES TO BE COMPLETED BY: 9/15/07

Practice No. & Component Title	Quantity Requested	Quantity Approved	Maximum C/S Amount	C/S Amount Requested	C/S Amount Approved
9 666-6	2		1,200.00		
3,7,9 666-4	2		300.00		

Total: _____

Request for cost-share assistance under this program is to meet the objective stated in the management plan. If cost-sharing is approved for the practice requested, I agree to cover expenses at the time of implementation, knowing I will be receiving cost-share funds not exceeding 50% of actual cost. **I understand that I will not be reimbursed for any expenses incurred prior to approval of my application.** Work must be completed according to approved plan and application, and must meet the standard set for each component. Practices must be maintained for a minimum of 10 years. There are no partial payments.

LANDOWNER SIGNATURE: *Steven A. Goodroad* DATE: MAY 16, 2007

CSFS FIELD REVIEW SIGNATURE: _____ DATE: _____
 (Additional USFWS guidelines addressed)

C/S APPROVED: *Wahneema Lubiano* AMOUNT: \$ 900.00 DATE: 6/8/07

Program eligibility is without regard to race, color, religion, national origin, age, gender, sexual orientation, veteran status or disability. For more information contact your local Colorado State Forest Service District Office.



FOREST LAND ENHANCEMENT PROGRAM PLAN DESIGN

Sketch project area and design. Include numbers, volumes, rows, lengths, species, etc., as appropriate. Include structures and landmarks. Indicate, by location, the practices to be implemented. Show distances. Illustrate road access. Use additional pages if needed for more detail.

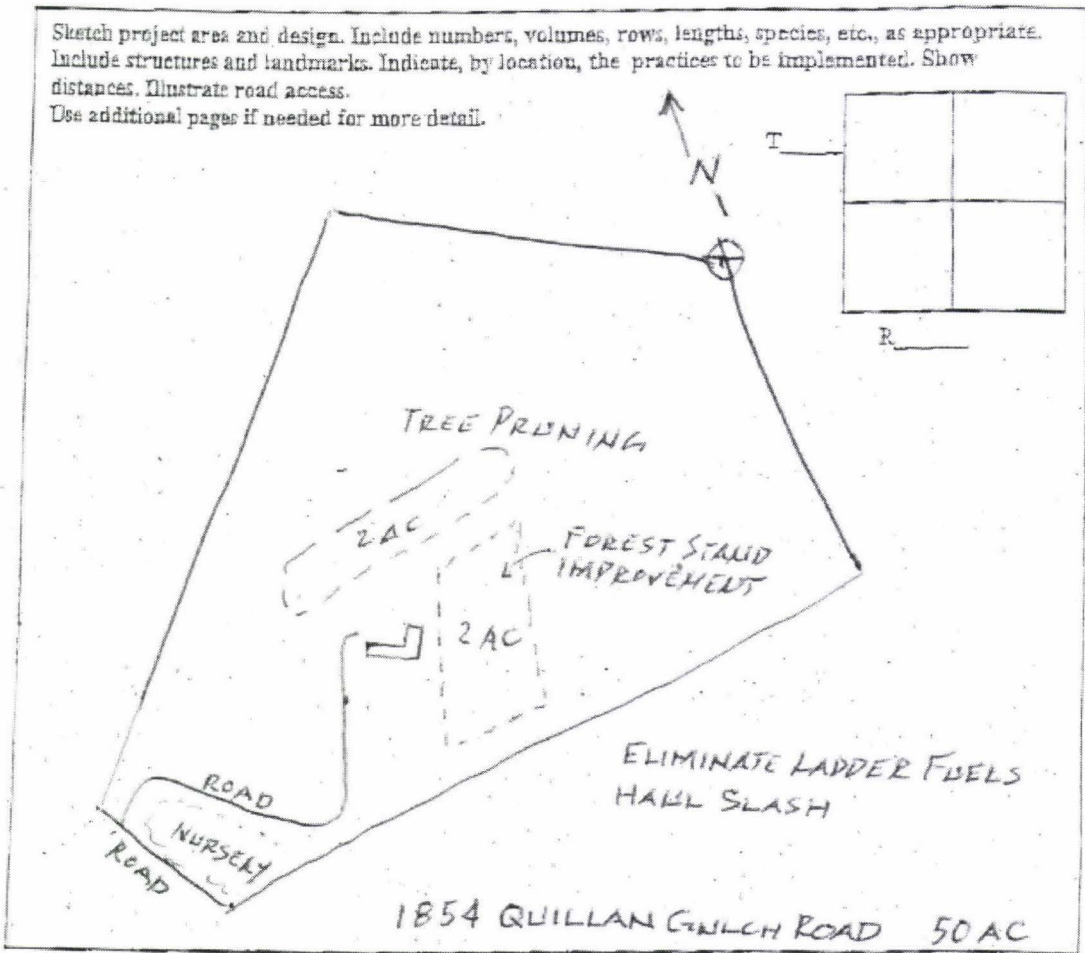

LIST PRACTICE AND COMPONENTS WITH IMPLEMENTATION SCHEDULE:

PRACTICE/COMPONENT/OTHER SPECIFICATIONS	COMPLETION DATE
REDUCE LADDER FUELS (FUEL BREAK)	9/15/07
TREE PRUNING	9/15/07
HALL SLASH	9/15/07